

DS CODE:
210202

LS Simple™ Cabling Solution

LS Simple™ Crimping Tool



Specification

- Operating/Storage Temperature Range : 10 °C~60 °C
- Humidity : 10%~90% RH
- Material : AL-ZN and steel with ratchet
- RoHS compliant

Part Numbers

Description	Part Number
Crimping Tool for Shielded Category 6/6A RJ45 Plug	LS-CT-SC6(A)-SI1

Drawings

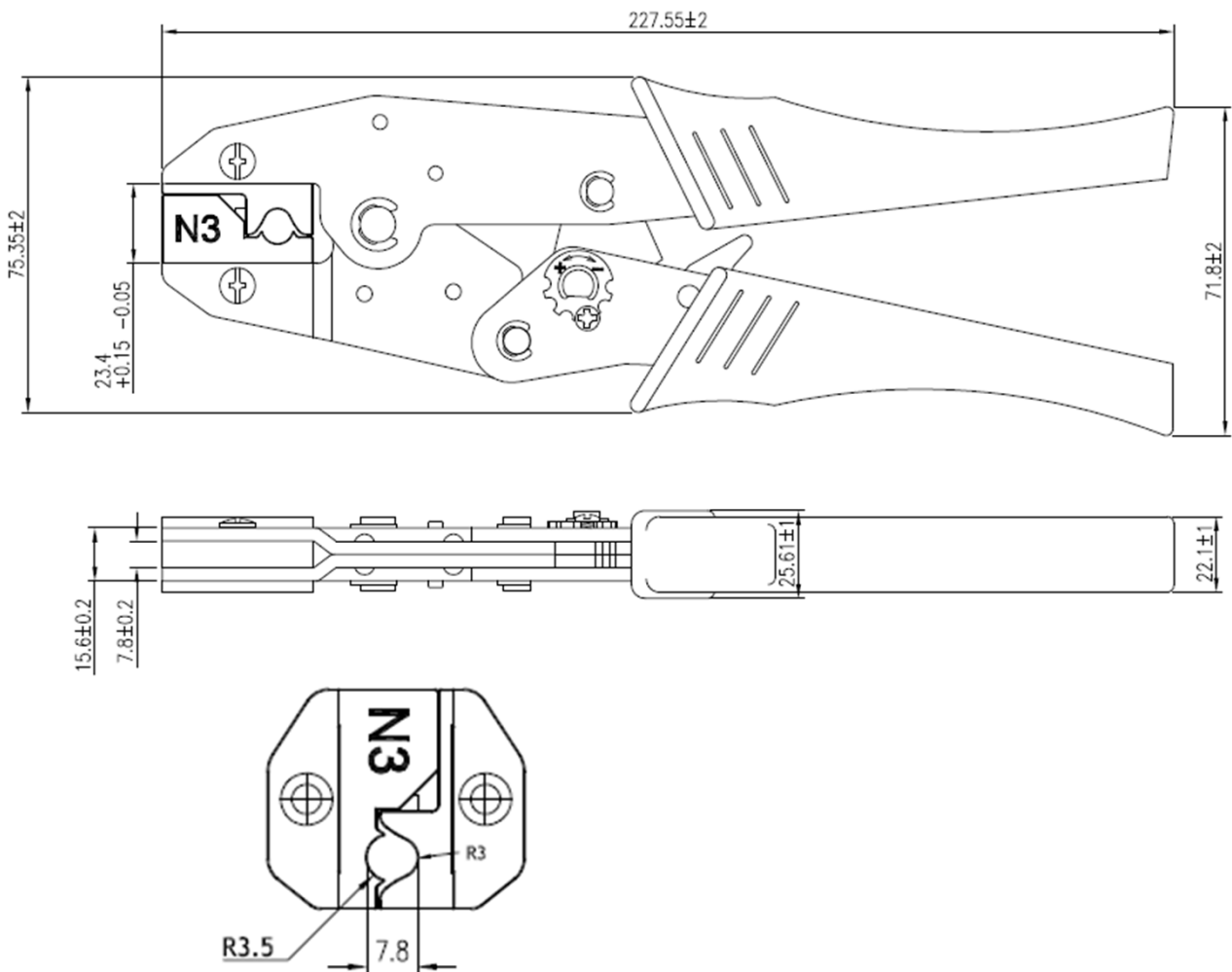

DS CODE:
210202

LS Simple™ Cabling Solution

LS Simple™ Crimping Tool

➤ Installation Instructions



1. Let cable through the boot then strip the cable jacket length about 30mm.



2. Bend back the copper braid or drain wire over plastic jacket and cut each pair's aluminum foil.
(in case of pair shielded cable)



3. Insert the separator and cut the wires straightly and leave the length approximately 15mm.



4. Push the cable into the plug housing, make it fit tightly inside the housing.

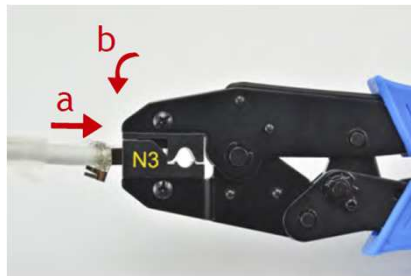

5. a. Put the plug into the crimp tool in the right position.
b. Squeeze the tool to push the contact blades into correct positions.

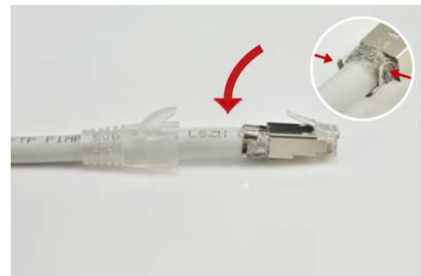

6. Push the metal strain relief down to hold the cable with copper braid or drain wire.

TIP: Adjust two foot toward inside. Next step will be done more easier.



7. Use the crimping tool to clamp the strain relief with cable.



8. Push the boot forward to terminate with plug.



9. completion.