

DS CODE:
210106

LS Simple™ Cabling Solution

LS-EZT-TOOL-ER

Description



It's easy termination tool for LS dedicated ERI type modular jack. It's applicable to both unshielded & shielded type. It's possible to reduce the efforts for IDC connecting when compared with general 1-pin IDC termination tool.

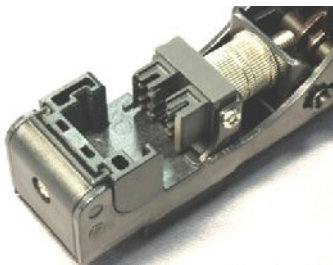

Specification

- Main body : Carbon steel
- Replaceable Blade: Alloy steel
- Blade life time: more than 2000 times
- Block oxide finished
- Jack Holder: High-impact PC+ABS resin, UL 94V-0 rated
- Grip: Polyvinylchloride(PVC resin), Blue
- RoHS compliant

Drawing

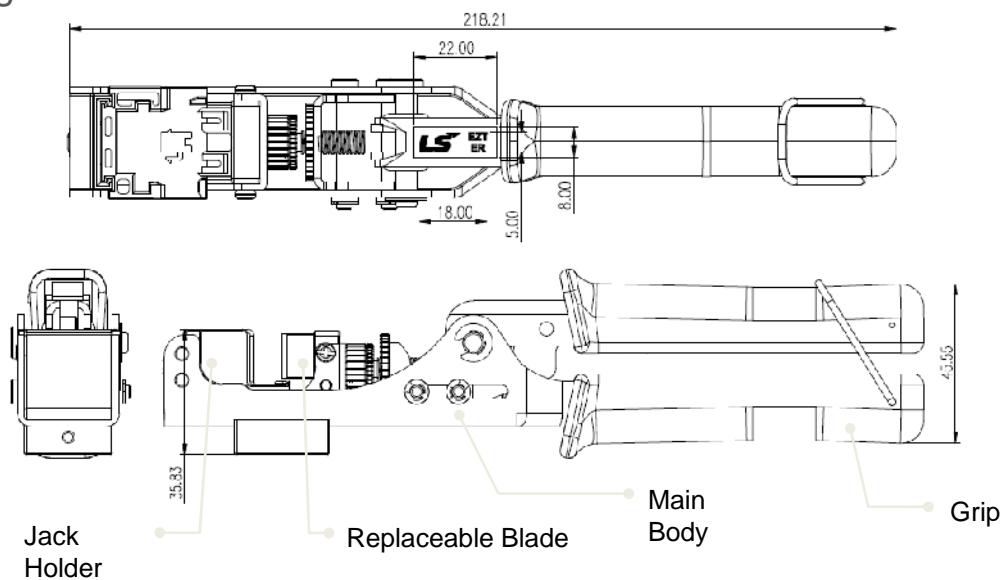

Part Numbers

Description	Part Numbers	Compatible Items
Easy Termination Tool for ERI type Modular Jack	LS-EZT-TOOL-ER	Unshielded & Shielded ERI type Modular Jack • LS-MJ-UC5E(6)(6A)-xx-ERI • LS-MJ-SC6A-xx-ERI

DS CODE:
210106

LS Simple™ Cabling Solution

LS-EZT-TOOL-ER INSTRUCTIONS (Unshielded)

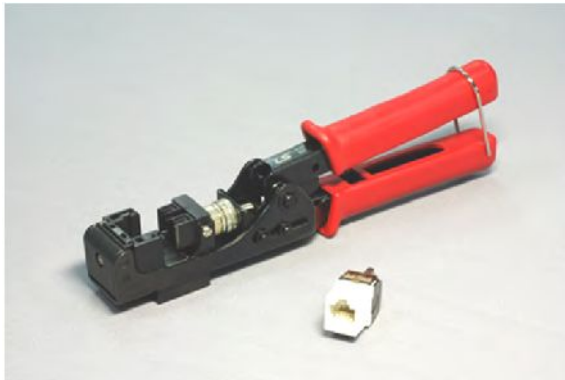

1. Prepare the EZT Tool with ERI type Modular Jack

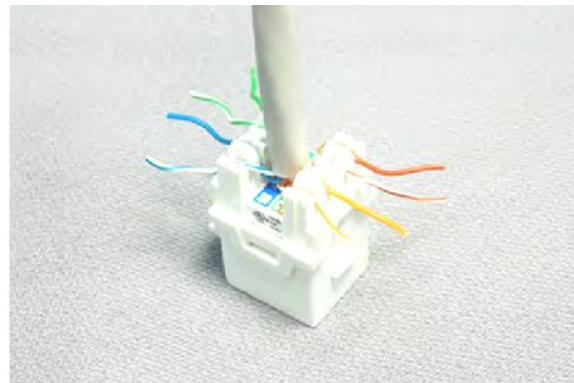

2. Place the wires into the wire slots according to the wire scheme.

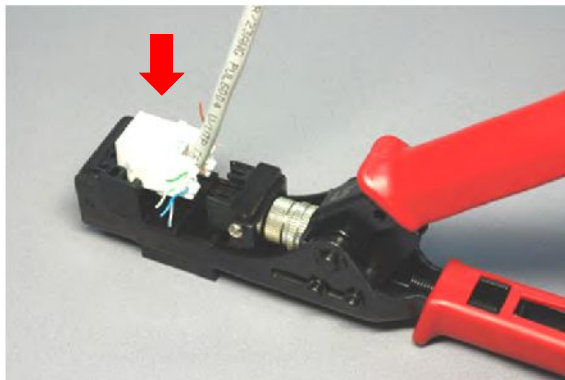

3. Put the Modular Jack into the termination tool in the right position.

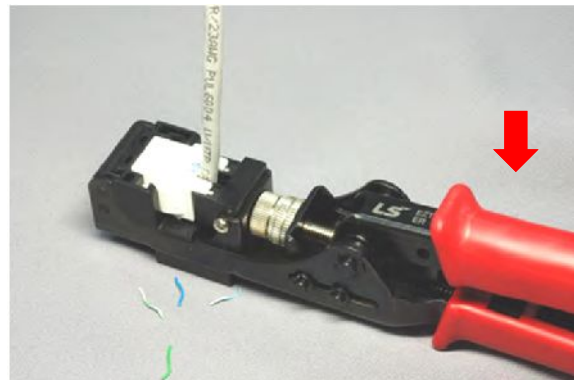

4. Squeeze the tool then terminate all wires and trim the excess wires at the same time.

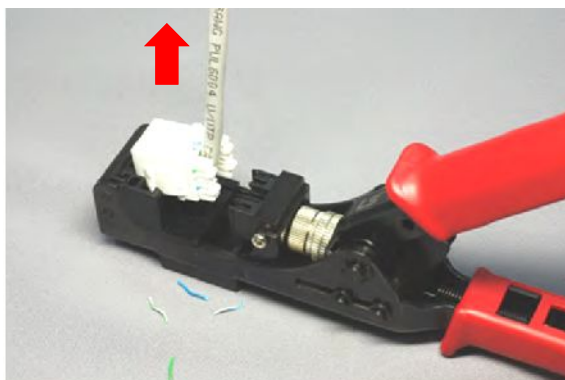

5. Remove the Modular Jack vertically away from the termination tool.

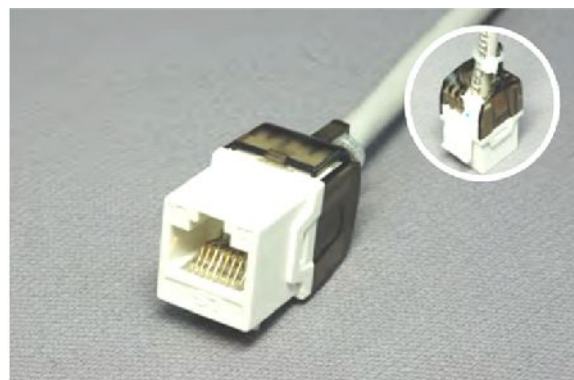

6. Place the cap & use the cable-tie to fix the cable. - Completion -

DS CODE:
210106

LS Simple™ Cabling Solution

LS-EZT-TOOL-ER INSTRUCTIONS (Shielded)



1. Prepare the EZT Tool with ERI type Modular Jack

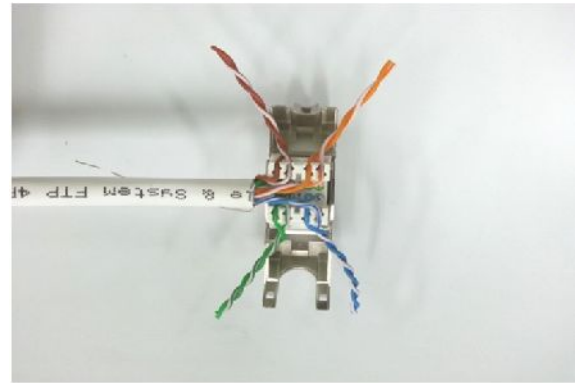

2. Place the wires into the wire slots according to the wire scheme.

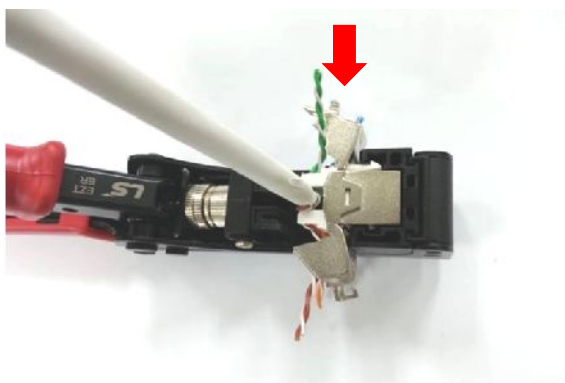

3. Put the Modular Jack into the termination tool in the right position.

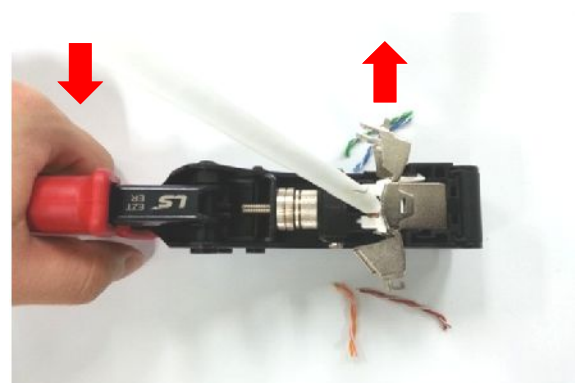

4. Squeeze the tool then terminate all wires and trim the excess wires at the same time and remove the Modular Jack vertically away from the termination tool.

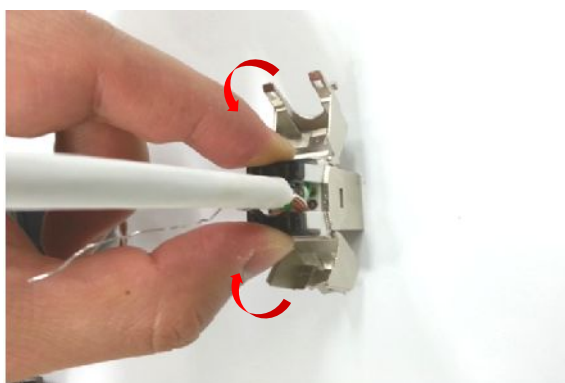

5. Place the cap & close the wing part of Modular Jack



6. Wrap the tinned copper wire around the designated position for Grd.
- Completion -