

DS CODE:

**200502**

## LS Simple Light™ S version Cabling Solution

### ERI-LED RJ45 Modular Jack (LS P/N: LS-MJ-UCC6-xx-SRI)



#### Description

LS Simple Light™ LED RJ45 S-version is compatible with all outlets and panels in simple™ Connectivity and the administrator can easily check horizontal cabling status with tracking device by LED light in front of Jack

This LED jack is implemented international standard ANSI/TIA Category 6 and ISO11801 channel performance and to meet long-term reliability coated over 50 micro inch gold coating on the insert pins

- 180 degree slim Modular Jack
- High impact flame retardant plastic housing
- Easy installation & smart cabling arrangement by wiring cap
- Available with easy termination IDC tool
- RoHS compliant

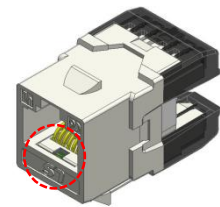

↻ Possible to port tracking in TR by LED Lighting of jack

↻ Easy finding Channel(patching with switch) & Link(Non-patching on Switch) status at outlet remotely

↻ Easy installation by using special tool (Four times more fast)

↻ High reliability by 180-degree Rear IDC structure & 50u-inch AU coating in front of insert pins

#### Application

- Horizontal Distribution & Backbone Cabling
- 4/16 Mbps Token Ring (IEEE 802.5)
- 10/100/1GBase-T (IEEE 802.3)
- 155 Mbps
- Full broadband and baseband video
- ATM LAN 1.2G
- 100Mbps TP-PMD
- ISDN, ADSL
- Analog & Digital Voice(VoIP) and Video
- PoE & PoE+(Inter-connection)

DS CODE:

**200502**

LS Simple Light™ S version Cabling Solution

**ERI-LED RJ45 Modular Jack (LS P/N: LS-MJ-UCC6-xx-SRI)**

 **제품 코드**

제품 설명	제품 코드
Cat.6 UTP Keystone Jack White Color, Enhanced RIDC type, LED	LS-MJ-UCC6-WH-SRI
Cat.6 UTP Keystone Jack Black Color, Enhanced RIDC type, LED	LS-MJ-UCC6-BK-SRI
Cat.6 UTP Keystone Jack Blue Color, Enhanced RIDC type, LED	LS-MJ-UCC6-BL-SRI
Cat.6 UTP Keystone Jack Red Color, Enhanced RIDC type, LED	LS-MJ-UCC6-RD-SRI
Simple Light™ port tracking device	TESTER LS-SCS-MS

DS CODE:

**200502**

LS Simple Light™ S version Cabling Solution

**ERI-LED RJ45 Modular Jack (LS P/N: LS-MJ-UCC6-xx-SRI)**

**➤ Technical Details**

Item	Unit	Information
<b>FEATURE</b>		
Approvals		-
Category		ANSI/TIA-568-C.2 Category 6 , ISO/IEC11801
Meet		47 CFR part 68
Wiring scheme		T568A/T568B
<b>ELECTRICAL</b>		
Current Rating	Amps	1.5
Insulation Resistance	Mega-ohm	> 500(connecting plug)
Contact Resistance	milli-ohm	< 20
	ohm	<0.1
<b>MECHANICAL</b>		
Mating Cycles		750
Insertion Life	lbs(N)	20(89)
Pull Force	°C	-40 ~ 70
Temperature	% (RH)	10 ~ 90
Humidity	AWG	23~26 (Solid wire) (0.57 ~0.38mm)
IDC accept		
<b>PHYSICAL</b>		
Housing		PC UL 94V-0 rated
PCB		FR4, 1.6mm Thickness UL94V-0 RoHS2
Jack Wiring		0.43mm Phosphor Bronze Plated with 1.27um Thick Hard Gold on contact Area over Nickel under plate
Connector		IDC(Insulation Displacement Connector) Accept 0.57mm ~ 0.38mm Solid wire
Guider		PC, Transparency white color UL 94V-0
Wiring cap		PC UL 94V-0, Transparent Black color
IDC Holder		PC UL 94V-0, White color
LED		True green color

DS CODE:  
**200502**

LS Simple Light™ S version Cabling Solution

**ERI-LED RJ45 Modular Jack (LS P/N: LS-MJ-UCC6-xx-SRI)**

**Drawing & Photo (LED Jack)**

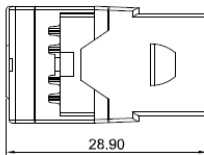
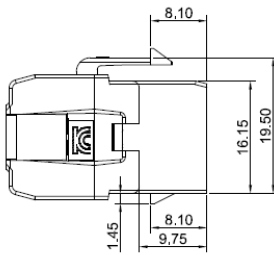
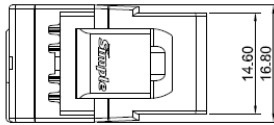

Lead: True Green Color

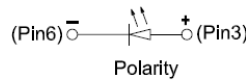
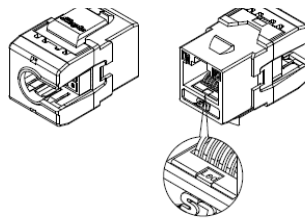
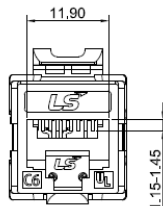

**LED LIGHTING**

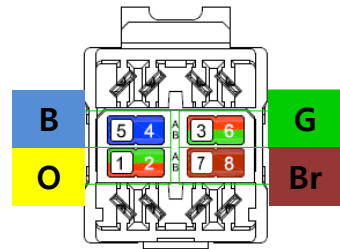

DS CODE:  
**200502**

## LS Simple Light™ S version Cabling Solution

### ERI-LED RJ45 Modular Jack (LS P/N: LS-MJ-UCC6-xx-SRI)



1. Prepare the Easy termination tool with ERI modular jack.



2. Place the wires into the slots according to the wire scheme(T-568A or T-568B)

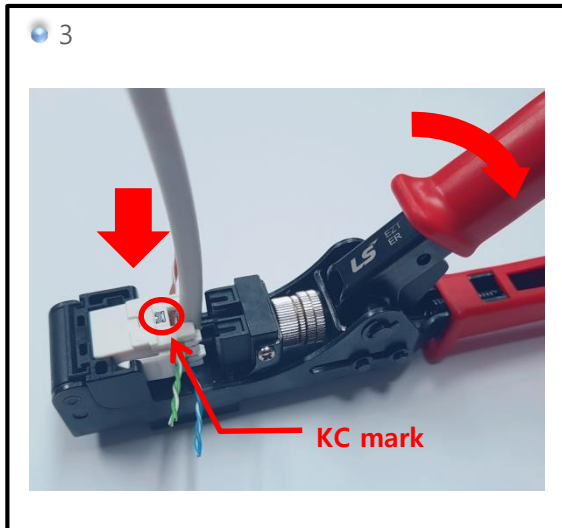

3. Put the Keystone jack onto the easy tool in the right position (check the KC make).

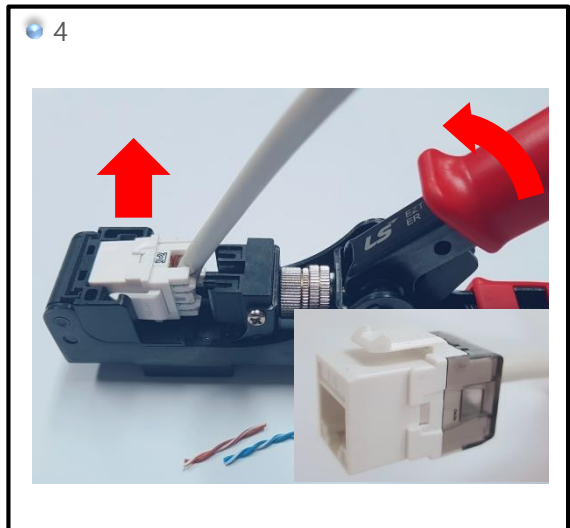

4. Remove the keystone jack vertically away from the termination tool. and insert IDC cap.

DS CODE:

200502

LS Simple Light™ S version Cabling Solution

ERI-LED RJ45 Modular Jack (LS P/N: LS-MJ-UCC6-xx-SRI)

5. Place the cap and be completion and adjust cable direction.

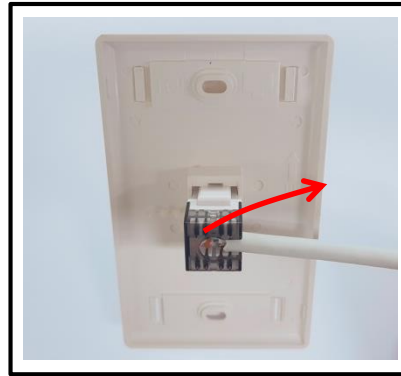
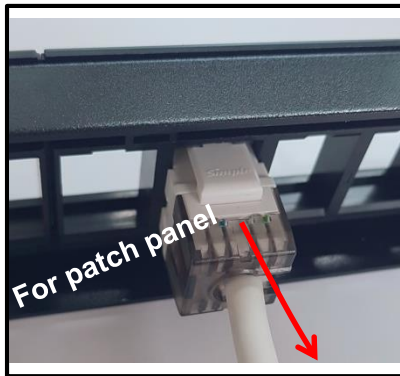
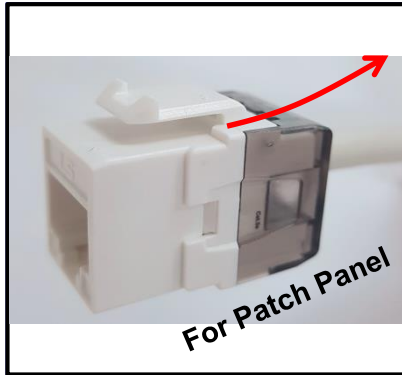

**UNINSTALL**

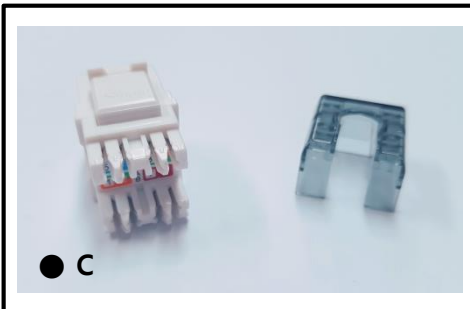
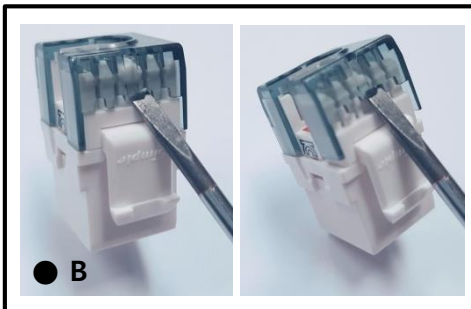
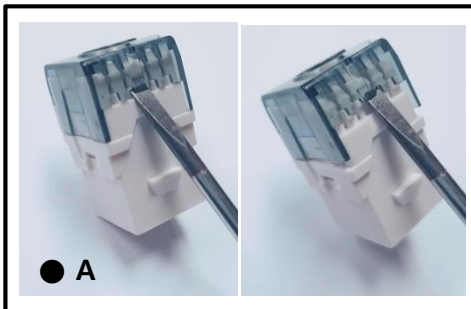

※ A. Inert the screwdriver into the slot between Cap & Jack Housing.

Use the screwdriver to pry the lid

B. Repeat the step A to unlock the other side.

C Completion.

DS CODE:  
**200502**

LS Simple Light™ S version Cabling Solution

ERI-LED RJ45 Modular Jack (LS P/N: LS-MJ-UCC6-xx-SRI)



[LS-SCS-MS]

Network  
Telecommunication  
equipment

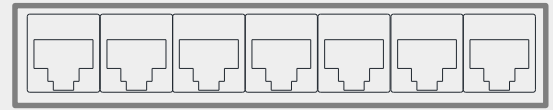

T/R

T/R  
Patch Cord



LED  
Panel

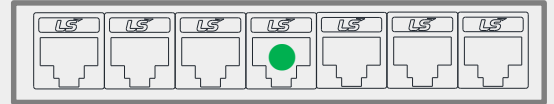

Horizontal Cabling (LINK)



Outlet  
Cord



[Cabling status check]

Cabling environment		LS-SCS-MS equipment		T/R LED Panel
Horizontal Cabling	T/R Patch Cord	Link	Patching	
Connection	Disconnection	OFF ●	OFF ○	BLINK ●
Connection	Connection	ON ●	ON ●	OFF ○
Disconnection at horizontal cabling or telecommunication equipment cord		OFF ○	OFF ○	OFF ○

[T/R patch panel port tracking]

LED PORT CHECK	LED panel
Pushing button	Unused port highlight ●

※ You can check the wire-map status by connecting master and slave to both ends and sequential LED lighting from slave.

[Wiremap test]



※ Generally available for 4 to 20 hours